

SAMPLE Earth Change Gladwin Conservation District

PERMIT APPLICATION For Part 91

SOIL EROSION AND SEDIMENTATION CONTROL

1. APPLICANT (Please check if the applicant is the land owner or designated agent*)

Name <input checked="" type="checkbox"/> Land Owner <input type="checkbox"/> Designated Agent		Date of Birth
John Doe		01-01-2001
Address		Drivers License #
111 My Street		D-xxx-xxx-xxx-xxx
City	State	Zip Code
Gladwin	MI	48624
		Phone Number
		989-426-xxxx

1. LOCATION

Section	Town	Range	Township	City / Village	County
6	17N	1W	Tobacco	Beaverton	Gladwin
Subdivision	Lot No.	Tax ID Number	Street Address		
LakeView sub	01	xxx-xxx-xxx-xxx-00	1114 RiverView Drive		

2. PROPOSED EARTH CHANGE

Project type: <input checked="" type="checkbox"/> Residential <input type="checkbox"/> Multi-family <input type="checkbox"/> Commercial <input type="checkbox"/> Industrial <input type="checkbox"/> Land Balancing / Mining		
Describe Project		Size of Earth Change (acres or square feet)
Modular Home on crawl with Attached Garage		1600 sqft
Name and distance to Nearest Lake, Stream or Drain		Date project to start
Wixom Lake - 25 ft		10-1-2015
		Date project to be completed
		04-15-2016

3. SOIL EROSION AND SEDIMENTATION CONTROL PLAN (Refer to Rule 323.1703)

Note: 2 Completed sets of plans must be attached	Estimated cost for Soil Erosion and Sedimentation Control
	300 ⁰⁰
Plan Preparers Name and Telephone Number	
Self	
Area Code () -	

4. PARTIES RESPONSIBLE FOR EARTH CHANGE

Name of Land Owner (if not provided in Box No 1)		Address	
Same			
City	State	Zip Code	Area code/Telephone Number
Name of Individual "On Site" Responsible for Earth Change		Company Name	
Bill Jones		Jones Excavating	
Address	City	State	Zip Code
100 Jones Road	Gladwin	MI	48624
		Area code/Telephone Number	
		989-426-xxxx	

5. PERFORMANCE DEPOSIT (If required by the permitting agency)

Amount Required \$	<input type="checkbox"/> Cash <input type="checkbox"/> Certified Check <input type="checkbox"/> Irrevocable Letter of Credit <input type="checkbox"/> Surety Bond
Name of Surety Company	
Address	
Leave Blank	
City	State
Zip Code	Area Code/Telephone Number

I (we) affirm that the above information is accurate and that I (we) will conduct the above described earth change in accordance with Part 91, Soil Erosion and Sedimentation Control, of the Natural Resources and Environmental Protection Act, 1994 PA 451, as amended, applicable local ordinances, and the documents accompanying this application.

Landowner's Signature	Print Name	Date
X John Doe	John Doe	09-09-15
Designated Agent's Signature*	Print Name	Date

*Designated agent must have a written statement from the landowner authorizing him/her to secure a permit in the landowner's name.

PLEASE INCLUDE THIS PAGE WITH SESC PLANS.

			✓ SITE PLAN CHCKLIST FOR SOIL EROSION PERMITS
Have	Need	N/A	
✓	✓		Drawing must be to scale (map scale: 1"=200' or less)
✓	✓		Site location map showing nearest road intersection
✓	✓		Legal description of property (i.e. T12N R4W Section 17 NW ¼, NE ¼.)
✓	✓		Location and size of each proposed earth change (clearly defined ON DRAWING)
✓	✓		Location and size of all temporary soil stockpiles
✓			Major geographic and vegetation features
		✓	Location and size of all tree lines and forested areas
		✓	Location and size of all existing buildings and structures
	✓		Soil information (on drawing or in written form)
✓	✓		Distance to nearest water body (lake, stream, river, county drain, wetland, etc.) for each proposed earth change.
✓	✓		Location of all existing and proposed drainage and dewatering facilities
✓	✓		Slope information or topography
✓	✓		Location and detailed description of all TEMPORARY erosion and sedimentation control measures (shown on drawing)
		✓	Location and detailed description of all PERMANENT erosion and sedimentation control measures (shown on drawing)
		✓	Maintenance program for erosion and sedimentation control measures (including person responsible)
✓			Timing and sequence of construction (construction schedule)

TYPE OF EARTH CHANGE

- | | | |
|--|--|--|
| <input checked="" type="checkbox"/> single family residence (new construction) | <input type="checkbox"/> commercial/industrial (new) | <input type="checkbox"/> road |
| <input type="checkbox"/> single family residence (addition/alteration) | <input type="checkbox"/> commercial/industrial (add./alt.) | <input type="checkbox"/> pipeline |
| <input checked="" type="checkbox"/> garage (addition or detached) | <input type="checkbox"/> residential development (subdivision, multi-family) | <input type="checkbox"/> utility |
| <input type="checkbox"/> pole barn | <input type="checkbox"/> recreation development | <input type="checkbox"/> school/church |
| <input type="checkbox"/> pool (in ground) | <input type="checkbox"/> golf course | <input type="checkbox"/> hospital |
| <input type="checkbox"/> pond | | <input type="checkbox"/> other _____ |

ADDITIONAL EARTH CHANGE INFORMATION

- | | | |
|--|---|---|
| Has earth-moving activity started? | Yes <input type="checkbox"/> | No <input checked="" type="checkbox"/> |
| Is the earth-moving activity over 1 acre? | Yes <input type="checkbox"/> | No <input checked="" type="checkbox"/> |
| Will the work be occurring in a wetland? | Yes <input type="checkbox"/> | No <input checked="" type="checkbox"/> if yes, contact MDEQ |
| Will de-watering occur? | Yes <input type="checkbox"/> | No <input checked="" type="checkbox"/> |
| Will work be occurring in a waterway/floodplain? | Yes <input type="checkbox"/> | No <input checked="" type="checkbox"/> if yes, contact MDEQ |
| Will a designated county drain be affected? | Yes <input checked="" type="checkbox"/> | No <input type="checkbox"/> if yes, contact Gladwin County Drain Office |
| Will fill be brought on site? | Yes <input type="checkbox"/> | No <input checked="" type="checkbox"/> Amount in cubic yards _____ |
| Will material be removed from site? | Yes <input checked="" type="checkbox"/> | No <input type="checkbox"/> Amount in cubic yards <u>10</u> |

APPROXIMATE PROJECT TIMING (Month/Year)

MINOR PROJECTS

10/15 Temporary Erosion Control Measures installed

10/15 Gravel Drive/Entrance Installed

10/15 Land Cleared or Excavation Started

03/16 Final Grade / Seeding

04/16 Permanent Erosion Measures in Place

04/16 Temporary Erosion Measures Removed

MAJOR PROJECTS

N/A

___/___ Temporary Erosion Control Measures installed

___/___ Gravel Drive/Entrance Installed

___/___ Land Cleared or Excavation Started

___/___ Detention/Retention /Sediment Ponds Installed

___/___ Road Construction

___/___ Utilities Installed

___/___ Final Grade / Seeding

___/___ Catch Basins/Ponds Cleaned

___/___ Permanent Erosion Measures in Place

___/___ Temporary Erosion Measures Removed

**Send Form To
Gladwin Conservation District
1501 N State Street
Gladwin, MI 48624**

Phone: 989-426-9461

Fax: 855-701-4369

EROSION CONTROL PLAN
LEGEND

(use key below to place needed objects on the plan, use a scale or ruler to draw home location and locate any other trees or buildings on your property. Please label roads. You only need to show the area that will be disturbed and the access drive.)

- Property Line -----
 - Existing Drainage - - - - ->
 - Temp. Diversion ...FD...>
 - Finished Drainage>
 - Limits of Grading
 - Silt Fence \$-----\$
- Show stone access drive, tree preservation and temporary soil stockpile.

DRAFT

Owner: James Smith
 Telephone: (989)555-5555

Scale 1 inch = _____ feet

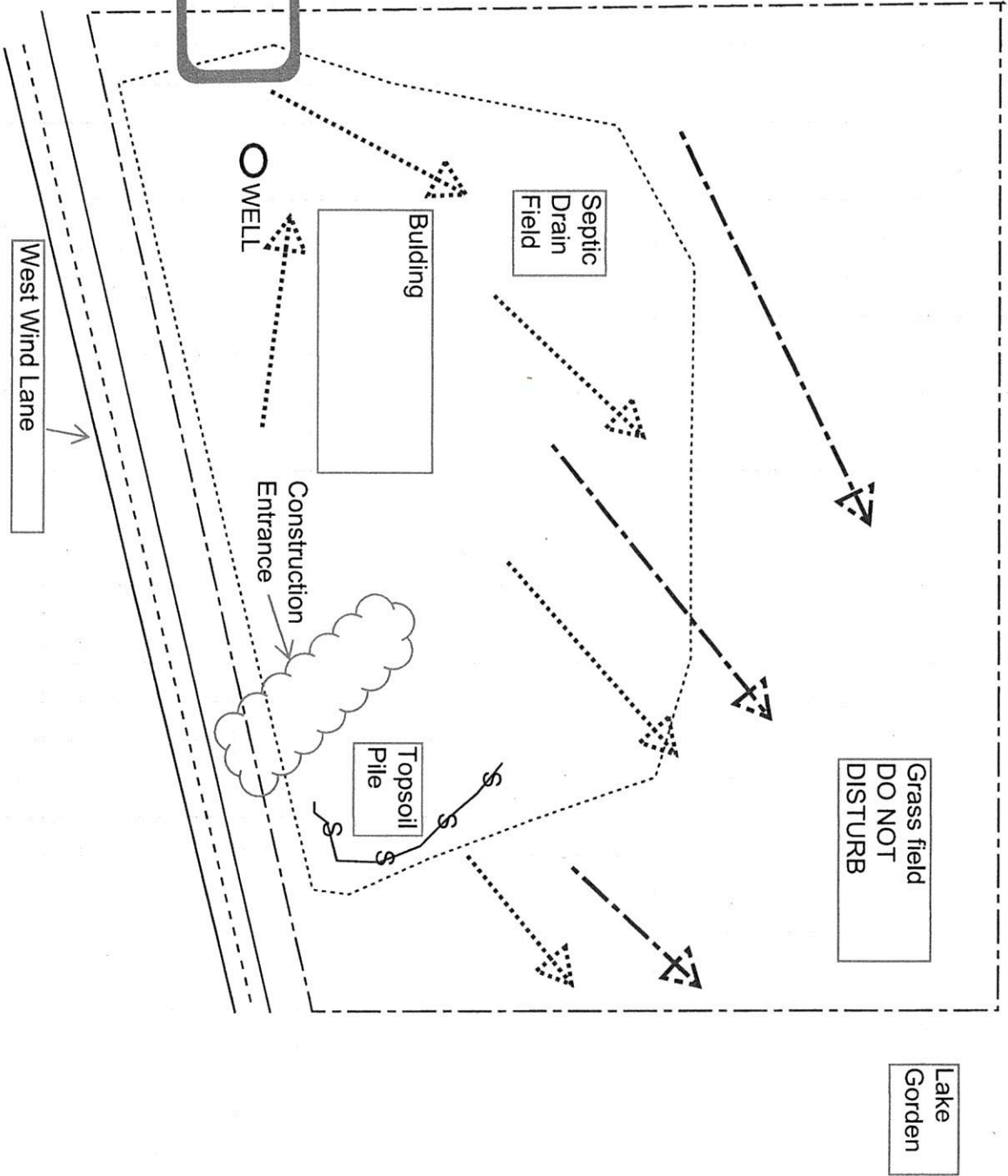

Address or location of Project: 1243 Wild West Lane City State Zip.

EROSION CONTROL PLAN

LEGEND

(use key below to place needed objects on the plan, use a scale or ruler to draw home location and locate any other trees or buildings on your property. Please label roads. You only need to show the area that will be disturbed and the access drive.)

Property Line - - - - -

Existing Drainage - - - - -

Temp. Diversion ...FD...>

Finished Drainage>

Limits of Grading - - - - -

Silt Fence - S - S -

Show stone access drive, tree preservation and temporary soil stockpile.

Owner: John Doe
 Telephone: (907) xxx-xxxx

Scale 1 inch = 20 feet

Address or Location of Project:

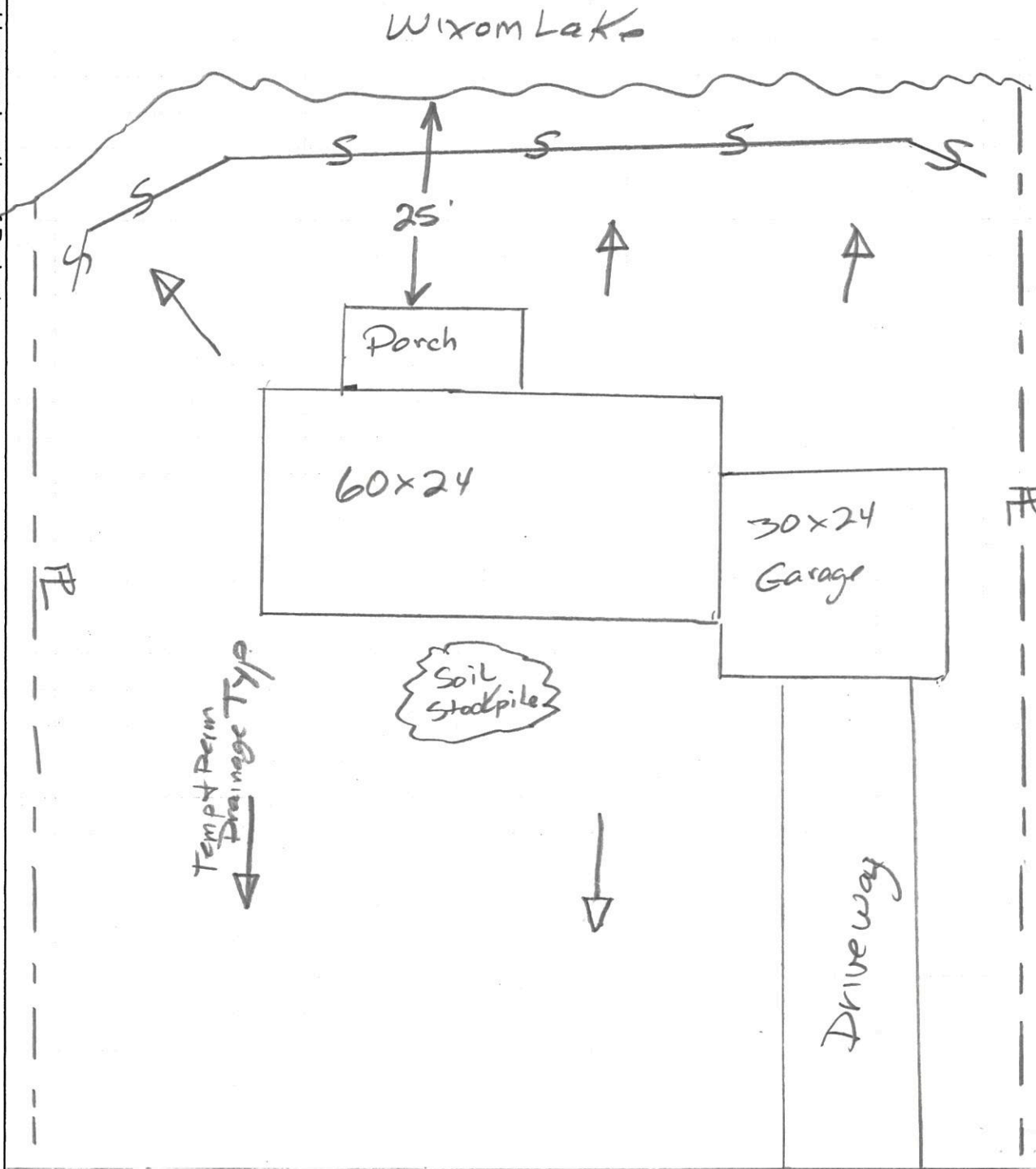

**GLADWIN COUNTY
SOIL EROSION AND SEDIMENTATION CONTROL**

EFFECTIVE IMMEDIATELY, the State requires each Authorized Agent applying for a Soil Erosion Permit on behalf of another person to include a Statement authorizing him/her to secure the permit. Please have the landowner complete this Letter of Authorization to be submitted with the application.

LETTER OF AUTHORIZATION

Needed if Contractor to Apply for Permit

_____ is authorized to secure a
(Printed Name of Designated Agent)

Soil Erosion Permit in my name for a project requiring said permit at

(Address of Project Location)

(Printed Name of Landowner)

(Signature of Landowner)

Date

(Signature of Designated Agent)

Date

Frequently Asked Questions about Soil Erosion Permits

Do I need a Soil Erosion Sedimentation Control permit?

Soil erosion permits are required for all projects involving earth moving activities that occur within 500 feet of lakes, streams, drains and water impoundments and disturb more than 225 square feet or disturb one or more acres. Soil Erosion exemptions are allowed for those projects that:

- Disturb less than 225 square feet and are stabilized within 24 hours
- Include only post holes for decks
- Include only borings and percolation tests when stabilized within 24 hours of the initial earth change and disturb less than 225 square feet
- Include only shrub and tree removal when no vegetation is disturbed
- Include only the plowing and tilling of fields for crop production

There's no water on my site, why do I need a permit?

Proximity to drainage ditches, drainage swales, catch basins, detention or retention basins, wetlands, and designated drains must be taken into account. These may appear dry for much of the year, but all serve a vital role in the conveyance of surface water, and can carry sediment into larger bodies of water.

What is the definition of a body of water?

A lake is defined as "the Great Lakes and all natural and artificial inland lakes or impounds that have definite banks, a bed, visible evidence of continued water, and a surface area of water that is equal to, or greater than 1 acre". A stream means "a river, creek, or other surface watercourse which may or may not be serving as a drain as defined in Act No. 40 of the Public Acts of 1956, as amended, being section 281.1 et seq. of the Michigan Compiled Laws, and which has definite banks, a bed, and visible evidence of the continued flow or continued occurrence of water, including the connecting waters of the Great Lakes".

How do I complete the timing sequence?

The timing sequence gives us a general idea of when your project will begin and when it will be finished. It also lays out a sequence of steps to follow for erosion control. Temporary measures, such as silt fence, check dams, or vegetative buffers should be installed at the beginning of the project. A stone aggregate drive should also be installed at the start of construction. Permanent measures, such as grass, shrubs, pavement or other vegetation should be installed as soon as possible after final grading. Removal of temporary measures should be done after the site is completely stabilized. For major projects please note in determining a timing sequence, detention/retention/sediment pond installation should occur at the beginning of a project and that catch basin covers should be cleaned at least once a month until permanent measures are functioning.

How big is an acre?

One acre is 43,560 square feet, or 208' x 208' if square. Determine from your plans the areas where earthwork will occur and measure the areas length and width. Remember to include area for utilities, well, septic, fill brought in, lot grading, building structures and driveways.

What are impervious surfaces?

Impervious surfaces are areas that do not absorb rainfall, such as areas covered by pavement or structures. Pervious surfaces are areas that do absorb rainfall such as vegetated ground, woodlots and grasslands.

Who is the party responsible for ongoing maintenance of permanent erosion control measures?

The responsible party is the property owner and/or homeowners association for commonly held properties. Examples of permanent erosion control measures that may require maintenance are vegetation strips and storm water detention/retention areas.

Goal

The purpose of the Soil Erosion and Sedimentation Control Program is to serve the public by protecting the waters of the State of Michigan, and to ensure clean water for drinking, swimming, fish and wildlife habitat.

Why is Soil Erosion and Sedimentation Control Important?

Economic Reasons

- Excess sediment can increase the cost of treating drinking water and negatively affect the equipment used in the treatment process.
- Sites developed with sound erosion control avoid the costs of removing sediment from storm water structures. Clean sites are also more appealing to potential buyers.

Health & Safety Reasons

- Eroded soils enter water bodies and channels, raising water levels and blocking culverts, flooding surrounding land.
- Sediment can be deposited onto streets and roads by vehicles leaving the site or by storm water runoff. These sediments can make roadways dangerous.
- Soil particles carry pollutants such as pesticides, oil and herbicides, that enter water bodies along with the soil, creating unhealthy conditions for wading and swimming, and affecting water quality.

Environmental Reasons

- Sediment in water bodies can cover the eggs of fish and other organisms, preventing them from hatching.
- Excess sediment that is suspended in streams and rivers acts like sandpaper on fish and other organisms and can clog their gills, making breathing difficult.
- Sediment reduces light penetration, making photosynthesis more difficult for water plants.
- Soil particles absorb heat, raising the temperature of the water and driving off desirable fish populations.

Aesthetic & Recreational Reasons

- Clear water is more desirable for swimming, boating, canoeing and fishing than muddy water.
- Excess sediment builds up in lakes and rivers. This raises the water level but reduces water depth, which decreases canoeing and fishing opportunities.

Soil Erosion Control Requirements

- Earth moving activity can not begin without a Soil Erosion Permit. The Soil Erosion Permit must be posted and be clearly visible from the road.
- Soil erosion and sedimentation control measures as designated on plans and/or as required must be installed prior to any earth moving activities.
- Earth changes to a property must not adversely affect drainage to surrounding areas.
- Detention/retention/sedimentation ponds must be constructed and stabilized prior to other earth moving activities.
- Outlets of detention/retention/sedimentation ponds shall be designed and constructed to reduce the water flow to a non-erosive velocity. Rip-rap must be installed on all storm water outlets.
- All earth moving shall be designed, constructed and completed in such a manner that limits the exposed area of any disturbed land for the shortest possible period of time. The site must be stabilized within 5 calendar days after final grading or earth moving activity has been completed.
- Stone access drives, if required, must be installed prior to construction for purposes of mud tracking.
- Soil, sediment, and miscellaneous debris must be kept off streets and out of drainage ditches and catch basins throughout the duration of the project.
- Silt fencing, if required, must be trenched in and backfilled. Fencing may be toed-in with pea gravel if installed in winter.
- Stockpiling of any excavated material must be kept clear of sensitive areas. Adequate controls must be in place to ensure this requirement.
- Erosion control blankets are required on slopes of 4:1 or steeper.
- All permanent erosion control measures shall be permanently maintained by the owner or homeowner association.

Soil Erosion and Sedimentation Control Measures

CATCH BASIN FILTER Geotextile filter fabric placed inside a catch basin (storm drain) to filter suspended sediment from water. Must have regular maintenance after storm or snow melt events to function properly.

CHECK DAM Temporary measure consisting of a line of 4-8" stone piled a maximum of 2 ft. high that slows the flow of water in ditches, swales or natural drainage areas. Check dams should be built so that the center of the wall is lower than the outside edges, and should be spaced so that the top of the downslope check dam is level with the bottom of the upslope check dam.

DETENTION/RETENTION BASIN Drainage basins or ponds designed to hold and filter water draining from developed site so as to prevent flooding and filter suspended sediment from water. Required for most major projects.

EROSION CONTROL BLANKET A blanket composed of a mesh of biodegradable material, usually interlaced with straw mulch, and sometimes containing grass seed, used for controlling erosion on steep downslopes. Erosion Control Blankets must be staked in, trenched in at the top and flat against the ground.

RIP-RAP Rock-type material (usually 6-8' stone) placed on the edges of culverts or drainage outlets to slow water to a non-erosive velocity, preventing erosion. Stone should be arranged in a half-circle around the end of the outlet.

SILT FENCING Temporary measure consisting of wooden fence posts, support system, and a geotextile filter fabric (usually nylon) used to keep suspended soil particles from leaving the site. Required to be trenched in to a depth of 6".

VEGETATIVE BUFFER A strip or area of vegetation used to filter sediment and pollutants from runoff. The minimum width for a filter strip is usually 25'.

Methods of Acceptable Stabilization of Disturbed Soils

The best way to avoid soil erosion is to disturb the least possible amount of soil during grading and construction. If erosion control measures are not functioning properly, causing erosion to occur on the site, the site will not be considered stabilized.

MAINTENANCE IS THE KEY TO PROPER SOIL EROSION CONTROL!

Temporary Stabilization - These measures will temporarily prevent soil erosion.

- 1) **Mulch** - This typically is in the form of straw, spread heavily over a disturbed area to protect the exposed soil from rain and wind erosion. For proper stabilization, the soil must **not** be visible through the mulch. Mulch should be used:
In flat areas with a low amount of water runoff, and/or in areas with adequate protection from high winds

High velocities of run-off will wash away mulch on moderate to steep slopes. High winds can also carry mulch away. Spreading seed prior to mulching greatly aids in the permanent stabilization of the site.

- 2) **Erosion Blankets** - Consist of straw, coconut fiber or excelsior fiber packed in web netting. Erosion control blankets are suitable for moderate slopes and steep slopes on sites with soil that is susceptible to erosion. The blankets are laid at right angles over a disturbed area, staked in place, and toed in at the top of the slope, with a **6-inch overlap** of all edges. Blankets are also available with seed in them to enhance permanent stabilization of the slope. If rills (narrow-bands) and gullies (wide-bands) are eroding underneath the blankets, the soil will not be considered stabilized.
- 3) **Hydro Seed** - Hydro seed may be used as temporary stabilization on relatively flat areas with low volume of runoff. Hydro seed can wash away easily in heavy rains. It is recommended that hydro seed with a high content of mulch be used to provide a better barrier between the weather and the soil. If cared for properly, hydro seed will grow, stabilize the site, and provide permanent stabilization.
- 4) **Tarps** - These are plastic sheets used to cover stockpiles or small disturbances. They may not be used for large disturbances.

Permanent Stabilization - These measures will permanently prevent soil erosion when they are functioning properly. When all exposed soil at a site is permanently stabilized, the project will receive final approval from the Soil Erosion and Sedimentation Control Program.

- 1) **Established Vegetative Cover** - Any form of vegetation that provides a root base in the soil and a barrier between the soil and the weather can be considered permanent stabilization. Forms of acceptable vegetative cover when properly installed and maintained are sod, grass, native trees, shrubs and ground cover.
- 2) **Woodchips** - As part of landscaping a thick layer of wood chips or other "permanent" mulch is acceptable in non-sloped areas.
- 3) **Stone** - A thick layer of stone is considered permanent stabilization on all areas except steep slopes. This includes gravel drives, stone gardens, and pavers used for foot traffic. Geotextile fabric placed underneath stone in swales and drives is advisable.
- 4) **Pavement** - Roads or driveways are considered permanent stabilization.